



Safety Advice Sheet PLEASE READ BEFORE YOU BEGIN:

- Please read and understand the instructions before assembly.
- Incorrect installation of this product could result in personal injury or physical damage.
- WallBeds Australia recommends that eye protection is worn when
- assembling the product.
- The wall bed **MUST** be securely fastened to the wall. Failure to do so will cause the wall bed to tip over & may cause damage to the cabinet or serious personal injury.
- While these products are DIY, it is recommended a qualified tradesperson installs the wall bed if you are not comfortable with the installation of this product.

WallBeds Australia is not responsible for any damages or injuries incurred by the incorrect installation of this product.

NeXt Bed Cabinetry Assembly Labels

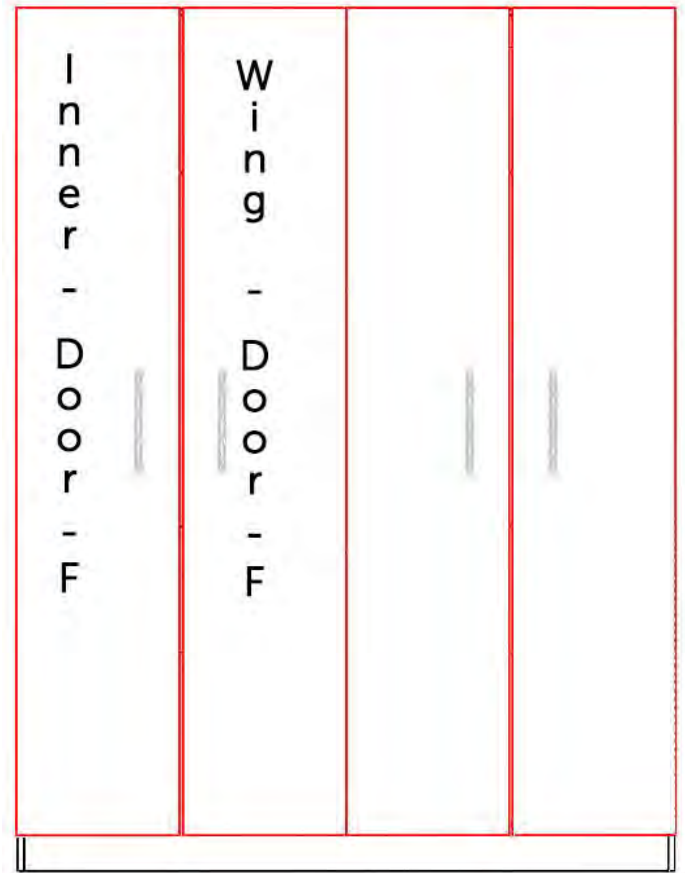
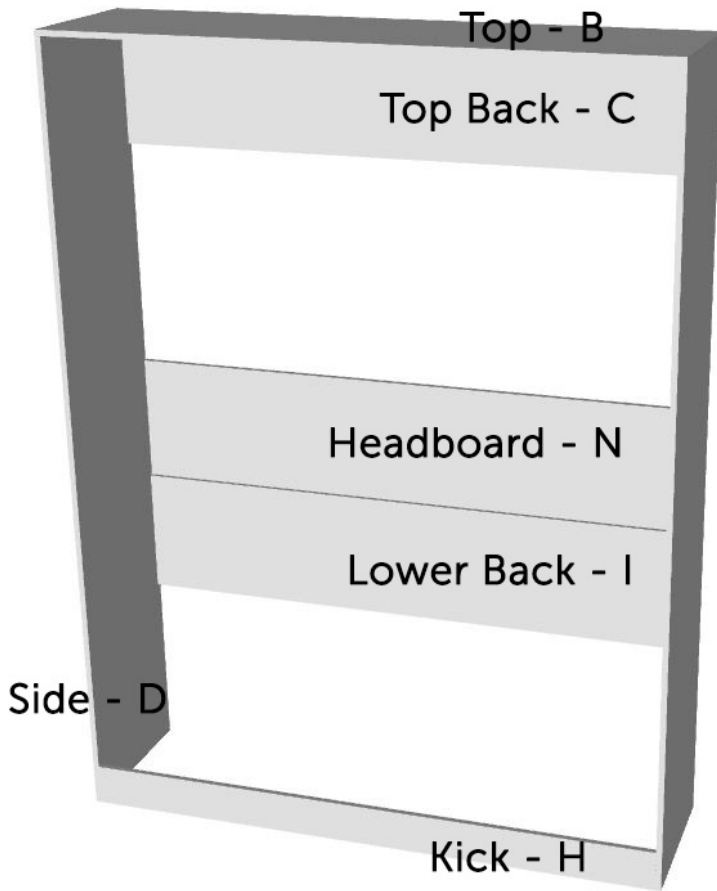

Step 1 – Inserting Drawer Cabinetry Hardware

Cam Locks – Insert all Cam Locks into the following panels as described by the cabinet part located on the cabinet sticker.



Top Panel - B



Kick - H



Top Back - C



Lower Back - I



NeXt Bed

Cabinetry Assembly Instructions

Panel Stickers/Labels – Do not remove any cabinet stickers from the panels until the units have been built, as these will assist with assembly. Most of the stickers are placed on the “back” or underside of the cabinet and will not be seen once assembled.

Example of the label sticker on each panel

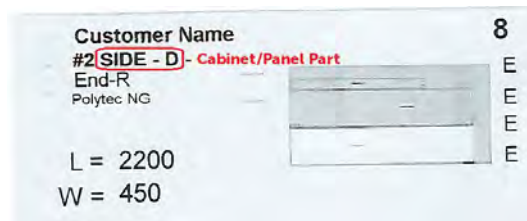

NeXt Bed Cabinet Hardware

Cam Lock



Cam Pin



"L" Wall Bracket



65mm Wall Fixing Screw



15mm Counter Sunk Screw
Magnet Plates, Hinge Arm,
Hinge Cup



Hinge Arm



Hinge Cup



Hinge Cap



Dome Head Screw



Fold Hinge



6g 12mm Panhead Screw



Magnet Block- Doors & Headboard



4g 12mm
Round Magnet Screw



Self Adhesive Magnets



Headboard Pin



Handle Screw



NeXt Bed Handle



Tools Required



Spirit Level



Stud Finder



Phillips Head
Screwdriver



Rubber
Mallet

Cam Pins Insert all Cam Pins into the following panels as described by the cabinet part located on the cabinet sticker.



End Panel - D

End Panel - D

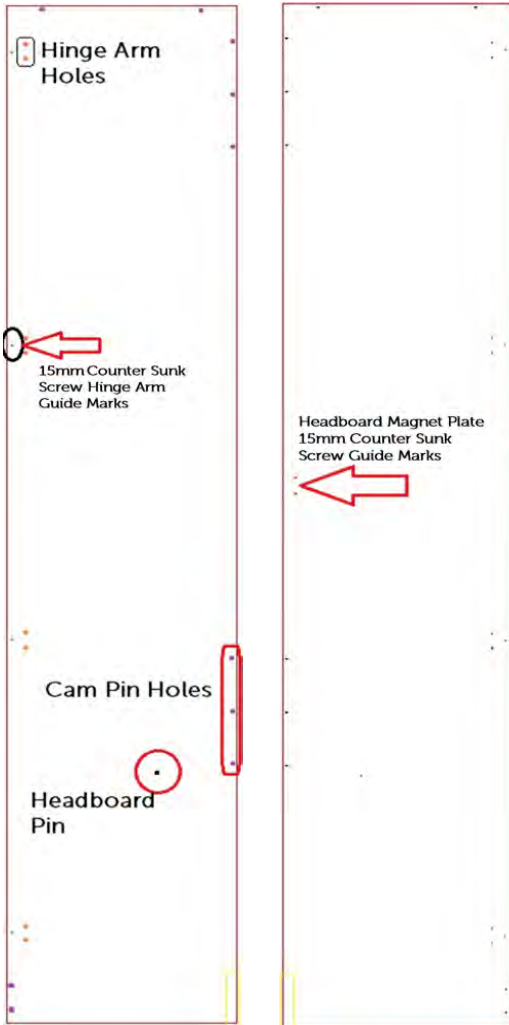

Top Panel - B



Headboard Fold Hinges

Place the Fold Hinge over the guide marks ensuring that the marks line up with the Dome Head Screw holes in the Fold Hinge. If they do not then turn the hinge plate around, attach the hinge by using the Dome Head screw.

NOTE – The Headboard will not close correctly if the Fold Hinges are not correctly installed. Refer to images 2 page 9.



Headboard Magnet Block Place the Magnet Block over the guide marks ensuring that the pre-drill holes are in the middle of the block. This will allow for adjustment that may be required after the Headboard has been fitted. Attach using the 12mm Panhead screws.

Refer to image 9 page 10.



Attach the following hardware prior to assembling the cabinetry

Hinge Arm, Hinge Cups, Headboard Magnet Strike Plate

- Insert the Hinge Arms into the two cabinet End Panels and tighten the Hinge Arm pre-fitted screws.
- Secure the Hinge Arm into position using the 8g 15mm counter sunk screws. *Refer to image 7 page 10*
- Insert the four Hinge Cups into the two Inner Door panels and fix into place using the 15mm Counter Sunk screws. Ensure that the front edge of the Hinge Cup is parallel with the edge of the door panel.
- Attach the Headboard Magnet Strike plate using two countersunk 15mm Counter Sunk screws.

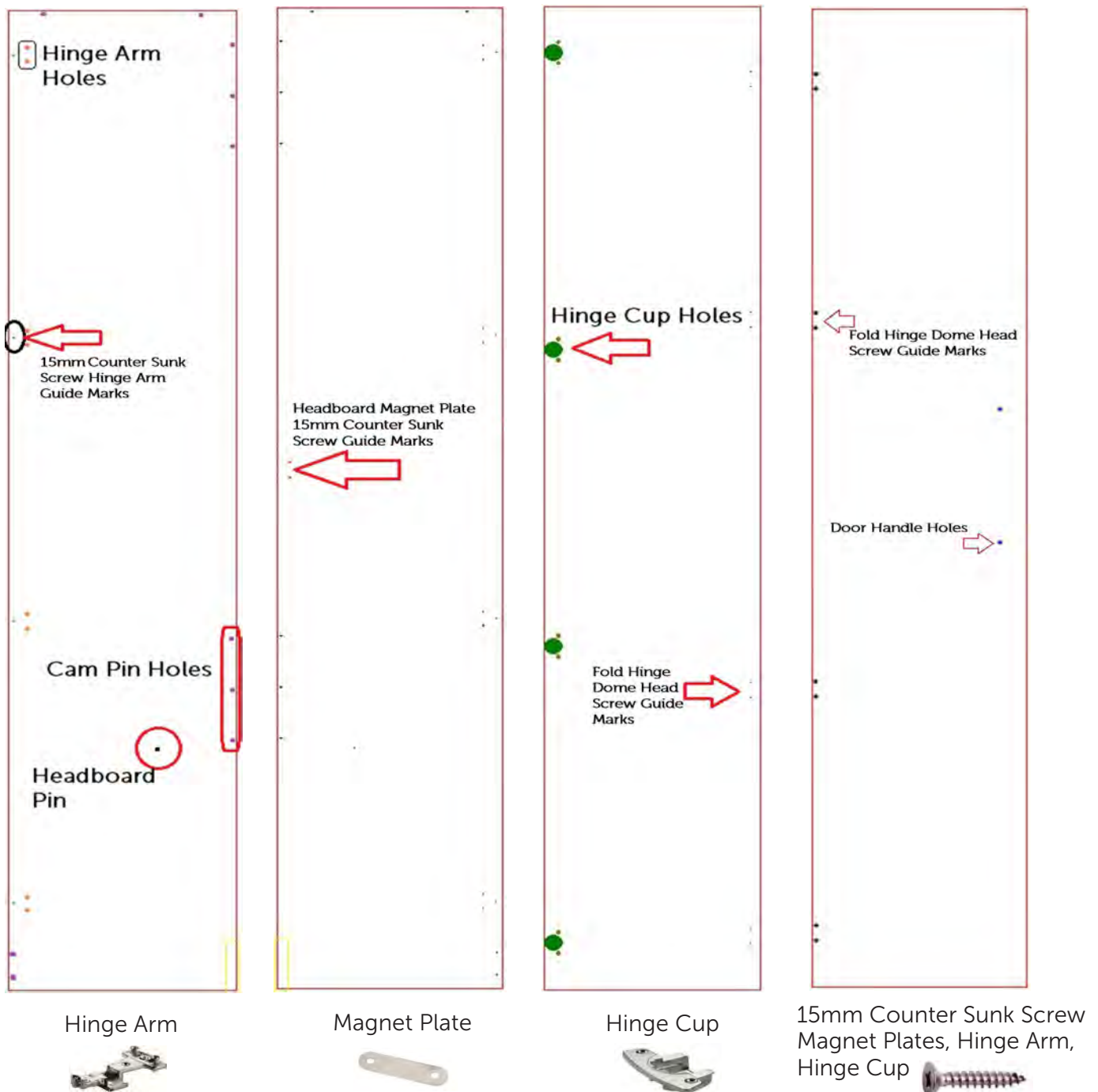

Step 2 - Door Panel Assembly

Match up the correct Inner and Wing Door Panels by ensuring the handle holes on both doors are in the centre

- **Tip** - To create an even gap between the two-door panels, place a small washer or 10c piece between the two panels at the top & bottom of the door panels.
- Place the Fold Hinge over the guide marks ensuring that the marks line up with the Fold Hinge fixing holes. If they do not then turn the hinge plate around.
- Fix using the Dome Head screws.
- After fixing the first Dome Head screw ensure that the centre of the Fold Hinge is still lined up with the gap between the two door panels. Then fix the next Dome Head Screw into the diagonally opposing Dome Head Screw location. Essentially you are fixing these screws in an **X** pattern.
- By attaching the screws in this manner it will prevent the centre of the Fold Hinge from going out of line with the centre of the two door panels.

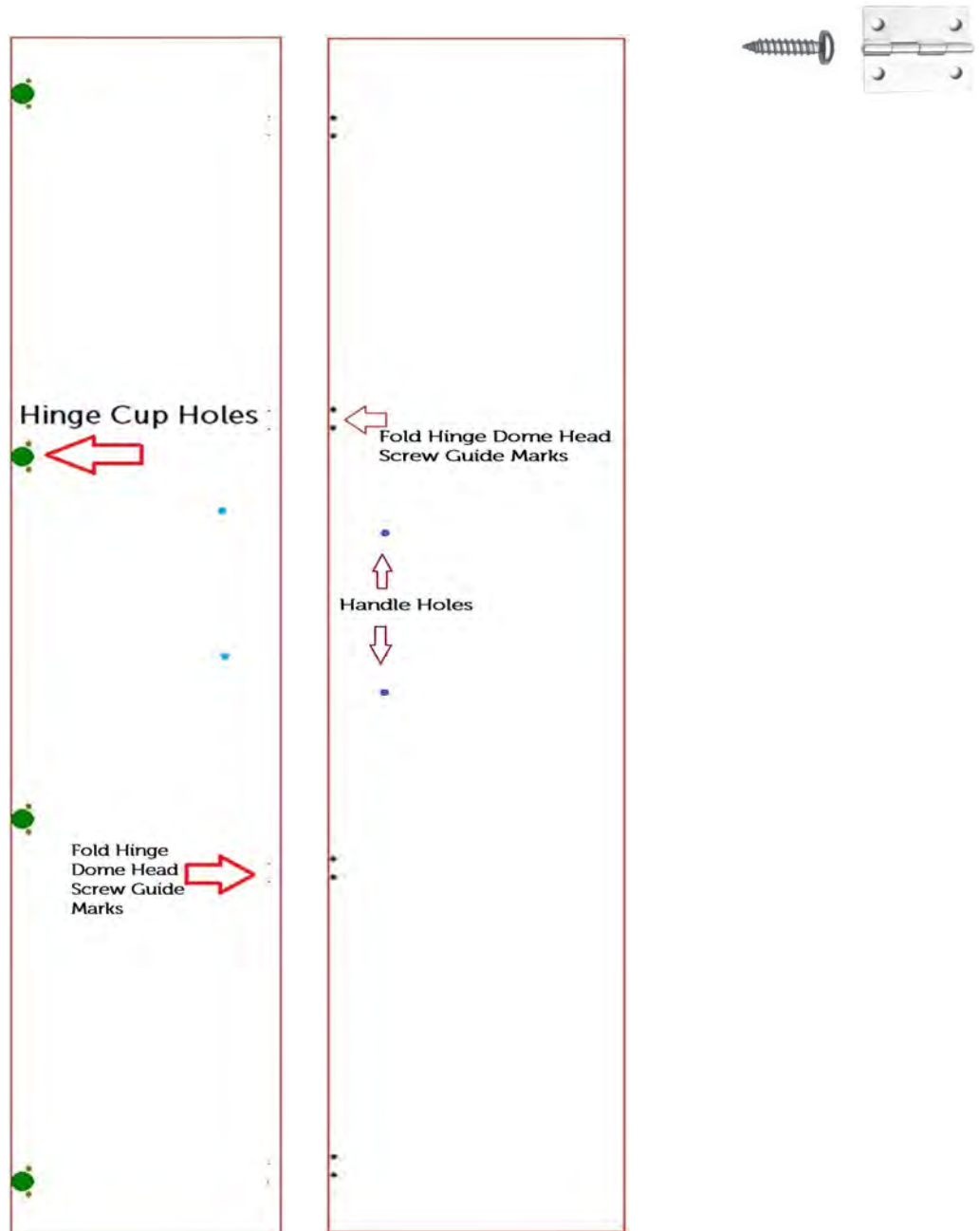

Step 3 - NeXt Bed Cabinet Assembly

WallBeds Australia recommends that a second person assists with the assembly of the cabinet and installation of the door panels.

When attaching all the cabinetry panels ensure that all cam locks are facing up or the outside of the cabinet. The Cam Locks should not be visible after the cabinet has been assembled.

It is recommended you use a hand Phillips screwdriver to tighten the cam locks to the cam pins, not a power tool.

Start the cabinet assembly by using either one of the Side/ End Panels and fixing it to the Back Panel. Ensure the cam locks are not facing the inside of the cabinet.

Important - Do not attach the doors or headboard until the cabinet has been secured to the wall.

TopPanel-B-

With the cam locks facing away from the inside attach the Top Panel to the Side/End Panel

KickPanel-H-

Attach the Kick Panel onto the Cam Pins in the Side/End Panels.

BackTop-C-

Place the Back Top Panel onto the Cam Pins in the Side/End Panels and the Top Panel.

BackLower-I-

Place the Back Lower Panel onto the Cam Pins in the Side/End Panels.

Tip- To get the Back Panels into position within the cabinet, lower one side past the cam pins until it is resting on the floor. Then slowly lower the opposite side until it is just past the cam pins.

Step 4 -Attaching the cabinet to your wall

Important - The fixing screws supplied are only suitable for timber wall studs. If your wall is not a wood stud wall, then you will need to use metal stud screws, toggle bolts or concrete expansion bolts as necessary.

- Locate two wall studs or other wall frame members at the level of the Top panel. *Refer to image 1 page 9*
- Using a spirit level to ensure the cabinet is level. If the cabinet is not level, you may need to use "packers" to achieve the cabinet being level.
- Measure diagonally to be sure the cabinet is square. The doors will not operate correctly if the cabinet is not square.
- Once the cabinet is square and level, use one 65mm wood screws in each of the two "L" brackets to attach to studs.
- Re-check the wall bed cabinet is square and level and then secure "L"-Brackets to the Top Panel (B) of the wall bed by using the Dome Head wood screws.



Step 5 - Attaching the Doors to the Cabinet

Ensure that the Hinge Arms are open.

- Place the Hinge Cups over the Hinge Arm to be clipped together. There will be an audible “click” if correctly clipped together. These may need to be lightly tapped into position with a hammer.
- Insert the Hinge Cap once the doors have been set into position.

Door Magnet Blocks

Using the 6g 12mm Panhead screws attach the 2 Magnetic Door blocks in the middle of the Top Panel - B where the two doors meet when closed. *See image 6 page 10*

Attach the magnet plates on the inside of the wing door opposite the magnet.

Tip – Place a small amount of double-sided tape onto the back of the magnet block & strike plate. Close the door and place the magnet block into position, hold the strike plate onto the door when opening. Then attach using the 15mm screws supplied.



Self Adhesive Magnets

- Place the larger Magnet onto the strike plate of the Wing Door. Close the Wing Door onto the Inner Door and press the two doors together firmly. Carefully open the door and the Round magnet should remain stuck to the Inner door.
- Close the door completely to ensure the Round magnet will not strike on the Top Panel of the cabinet. If the Round Magnet strikes on the Top Panel then reposition the Round Magnet lower on the strike plate.
- Place the Smaller Magnet at the bottom of the Wing Door close to the open corner. Place another small round magnet onto that magnet. Peel adhesive tape off the second magnet and close the Wing Door onto the Kick Panel of the cabinet. Ensure you press firmly where the two magnets are. Carefully open the door and the Round magnet should remain stuck to the Kick Panel
- Repeat process on both sets of doors.



Step 6 - Attaching the Headboard

To assist with creating an even gap of at least 5mm between the top of the Lower Back Panel & the Headboard, place washers in three locations along the top edge of the Lower Back Panel. The gap will allow for the lowering and raising of the headboard without the magnet scraping on the Side/End panel. *Refer to images 8 & 9 page 10*

Position the Headboard onto the washers and once in position, fix into place using the Dome Head Screws.

The magnet DOES NOT need to strike directly onto the magnet plate when closed as the strength of the magnet does not require it to make contact with the plate. If this occurs loosen off the magnet screws and move it back from the edge of the headboard.

Once the headboard has been attached, insert the Headboard Pin into the location on the Side/End Panel - D

Cabinetry Assembly Images

Image 1

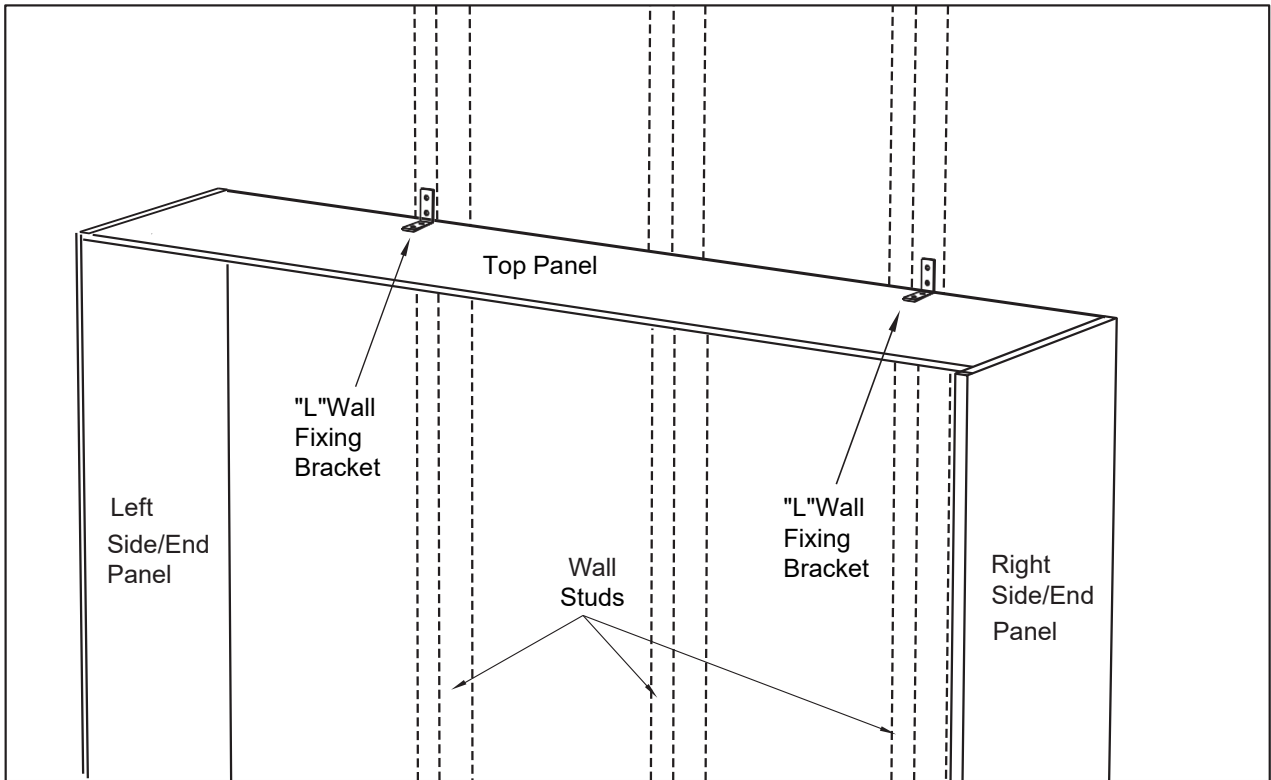

Image 2



Image 3

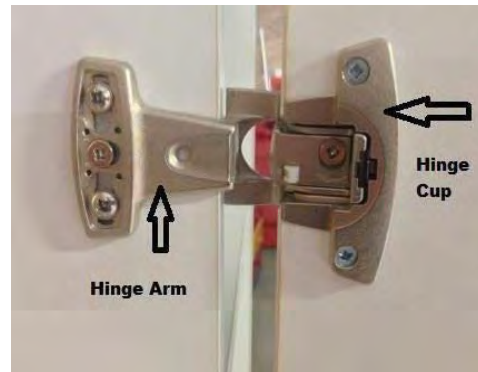

Image 4

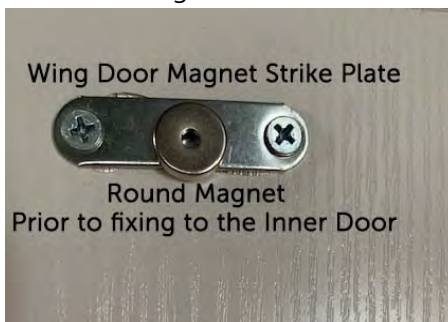

Image 5



Image 6



Image 7



Image 8



Image 9

